

Version 1  
September  
2020



## KEY LOCKING INSTRUCTIONS



Burton Safes  
Brockholes Business Park  
Rock Mill Road, Brockholes  
Holmfirth, HD9 7BN

[www.burtonsafes.co.uk](http://www.burtonsafes.co.uk)  
+44 (0) 1484 663388  
[enquiries@burtonsafes.co.uk](mailto:enquiries@burtonsafes.co.uk)

# USER INSTRUCTIONS - KEY LOCKING

## ABOUT THE KEY LOCK

The safes are supplied with 2 keys. Keep the keys in a secure place - but not in the safe! If both keys are lost, the safe will have to be forced open. Please note that the key will only fit inside the lock in one position. Do not force the key into the lock.

### How to open the safe

- Insert the key into the key hole
- Turn the key clockwise until it stops
- Rotate the handle until the bolts are fully retracted
- Open the door

NOTE: If your safe has dual key locking you must unlock the top lock first. If you have a dual key and electronic locking safe, unlock the key lock first then follow the Burton Duo instructions in the booklet for the electronic lock.

### How to close the safe

- Ensure that the bolts are fully retracted (if necessary rotate the handle)
- Gently push the door shut. Always ensure that there are no objects or people in the way of the closing door
- Turn the handle until the bolts are fully engaged
- Turn the key anti-clockwise until it stops
- Remove the key from the lock

## FIXING GUIDE

When fixing your safe, it is important that it is fitted against a solid wall or concrete floor. To fit your safe, identify the bolt that you have been provided with. Use the table to find out the size of drill and fixing hole you need to make. For more information and guidance visit our website.

BOLT	DRILL DIAMETER (mm)	MINIMUM DRILL DEPTH (mm)	TORQUE (Nm)
M10	10	170	40
M12	12	170	60
M14	14	150	80
M16	16	100	90



## FIXING GUIDE

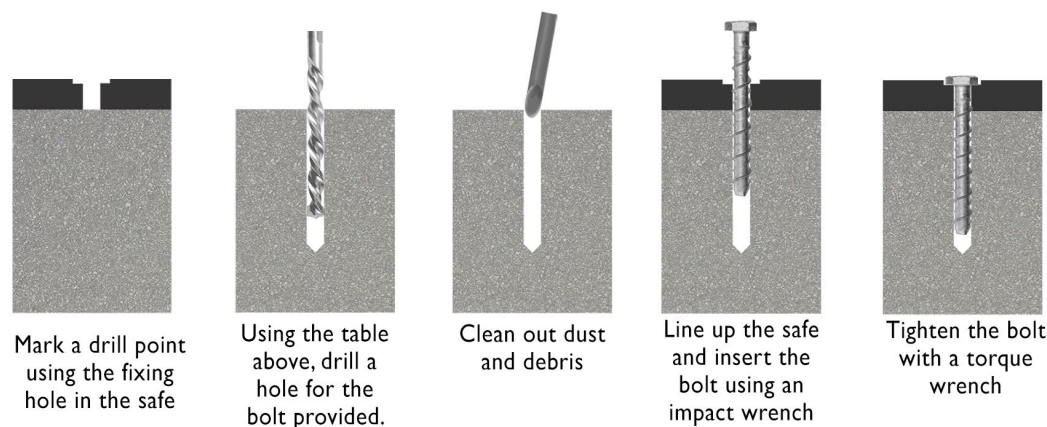

**BURTONSAFES**  
THE SURE DEFENCE.



## PRODUCT WARRANTY

Thank you for choosing Burton Safes.

Your new product carries a 2 year parts and labour warranty in respect of defects in materials and workmanship when registered on our website [www.burtonsafes.co.uk/warranty](http://www.burtonsafes.co.uk/warranty) or confirmed over the phone +44 (0) 1484 663388. Please also look out for the extended warranty and Safe for Longer stamps on the website or in our brochure.



5 Year extended warranty - At Burton Safes we are so confident in our products that we provide a 5 year extended warranty on all our Home Series safes for home consumers. Please register using the above details.



Safe for Longer - With all Safe for Longer stamped safes we provide a 5 year warranty and a **FREE REPLACEMENT\*** if your product is damaged during **BURGLARY** or **FIRE** for the life of the warranty Please register using the above details.

\*Ts & Cs apply, visit our website for full details.